

**CHATEAU DE
CANISY**
Canisy, France

SCHEMATIC DESIGN
& DESIGN
DEVELOPMENT

Project Type
French & Italian
Garden Expansion

Client
Chateau De Canisy

Dates
Schematic Design,
Design Development,
Construction
Document: 1988

Cost
\$100 million
Garden Design
/Landscape

Area
400 acres

Prime Consultant
John E. Bryan Inc.
Horticultural
Consultant

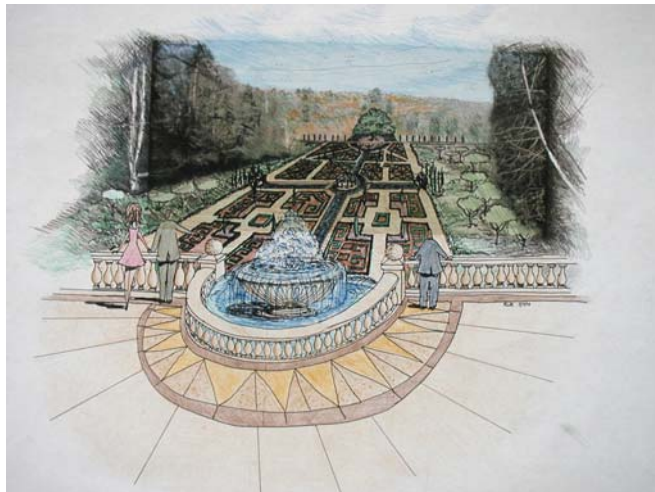
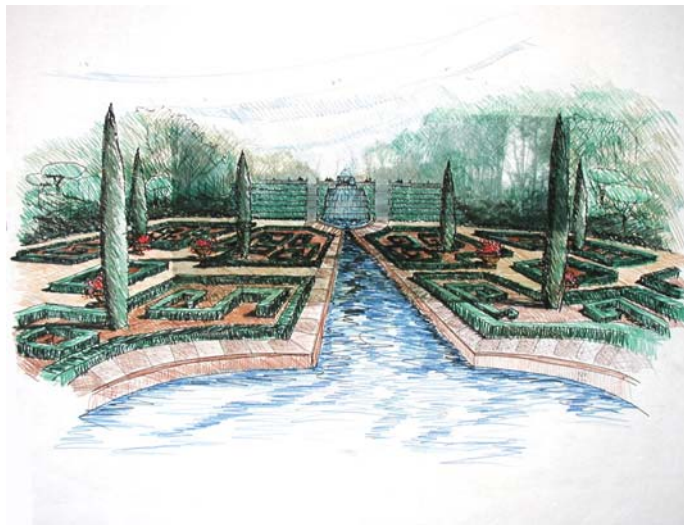

Description

Robert La Rocca & Associates was an Associate Consultant to Mr. John Bryan. The goal of the Chateau's owner was to develop more of their property into a more exciting garden experience. This was to encourage more tourists and visitors to Chateau de Canisy. The front of the Chateau was to become a traditional French Parterre and new Italian gardens were to be added in an adjoining valley at the back of the Chateau.